

4690 series

Turbidity sensors



Wiper blade replacement

Measurement made easy

4690 series
turbidity sensors

1 Introduction

This publication details the wiper blade replacement procedure for 4690 series turbidity sensors. The procedure must be carried out by a trained technician.

The contents of the wiper blade replacement kit is shown in Table 1.

Description	Part No.	Qty.
Wiper blade (pack of 4)	7998 023	2
This publication – Wiper blade replacement	INF11/068-EN	1

Table 1 Wiper blade replacement kit 7998 023

2 For more information

Further information is available from:
www.abb.com/analytical

or by scanning these codes:



Sales



Service

3 Replacing wiper blade

1. Isolate the turbidity sensor from the power supply.
2. Referring to Fig. 3.1:
 - a. Release wiper module retaining collar (1) and remove wiper module (2).
 - b. Clean the wiper module.
 - c. Pull wiper blade (3) out of slot (4) in wiper arm (5) and discard.
 - d. Ensure wiper arm is at right angles and slot (4) is straight and parallel.
 - e. Taking care not to damage the new wiper blade, slide it into the wiper arm slot (4), ensuring blade edge is facing outwards.
 - f. Restore the power supply to the turbidity sensor.
 - g. Ensuring wiper arm is not obstructed, hold wiper module securely and initiate a manual clean cycle – see Section 6 of the User Guide (IM/4690-EN).
 - h. When clean cycle is complete, ensure wiper blade stops in-line with cut-out (6) in wiper module flange.
 - i. Ensure O-ring (7) is undamaged and located correctly in wiper module groove.
 - j. Carefully insert wiper module (2) into cell body, ensuring cut-out (6) in wiper module flange engages correctly with locating lug on cell body.
 - k. Secure wiper module to cell body with retaining collar (1), tightening retaining collar hand-tight only.

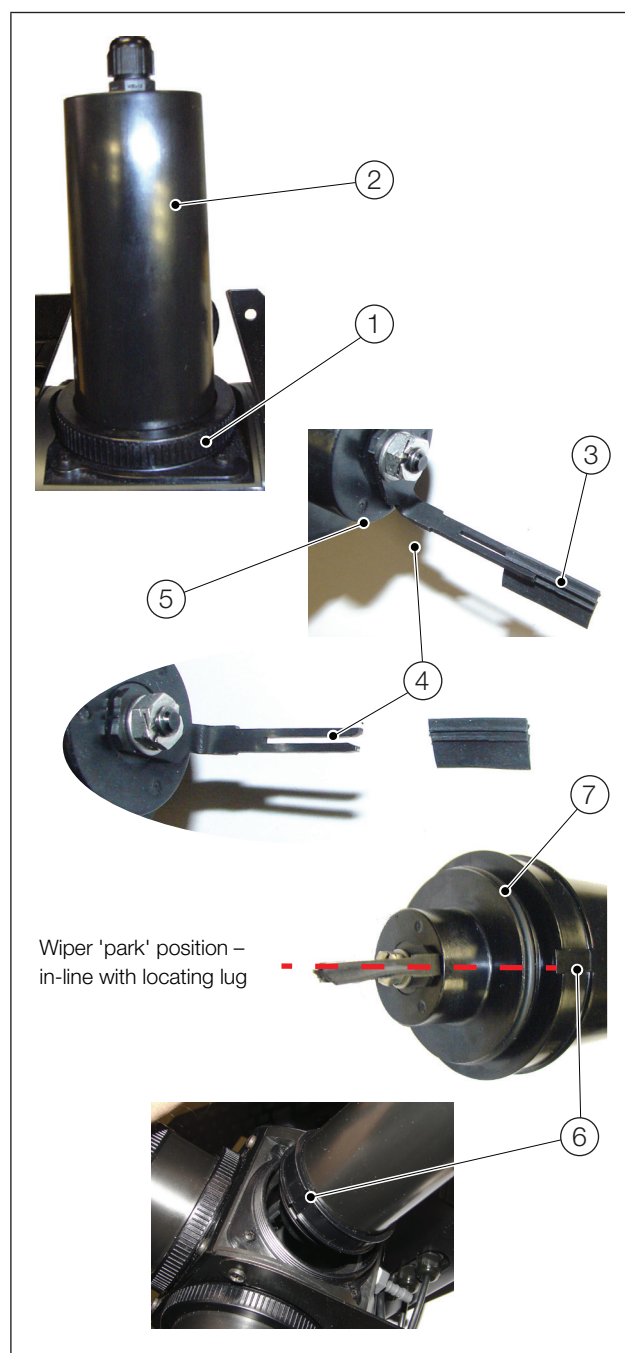

Fig. 3.1 Replacing wiper blade

Notes

ABB Limited
Measurement & Analytics

Oldends Lane
Stonehouse
Gloucestershire
GL10 3TA
UK
Tel: +44 (0)1453 826661
Fax: +44 (0)1453 829671
Email: instrumentation@gb.abb.com

ABB Inc.
Measurement & Analytics

125 E. County Line Road
Warminster
PA 18974
USA
Tel: +1 215 674 6000
Fax: +1 215 674 7183

abb.com/measurement



We reserve the right to make technical changes or modify the contents of this document without prior notice. With regard to purchase orders, the agreed particulars shall prevail. ABB does not accept any responsibility whatsoever for potential errors or possible lack of information in this document.

We reserve all rights in this document and in the subject matter and illustrations contained therein. Any reproduction, disclosure to third parties or utilization of its contents – in whole or in parts – is forbidden without prior written consent of ABB.

© ABB 2018